



Address:Wanxing Industrial Area, Chanjing Village, Xinxu Town,  
Huiyang District, Huizhou City, Guangdong, China,516000

www.goodlockers.com

Email:sales@goodlockers.com

Phone:+86 13632787893

## METAL WIRE MESH MILITARY LOCKERS

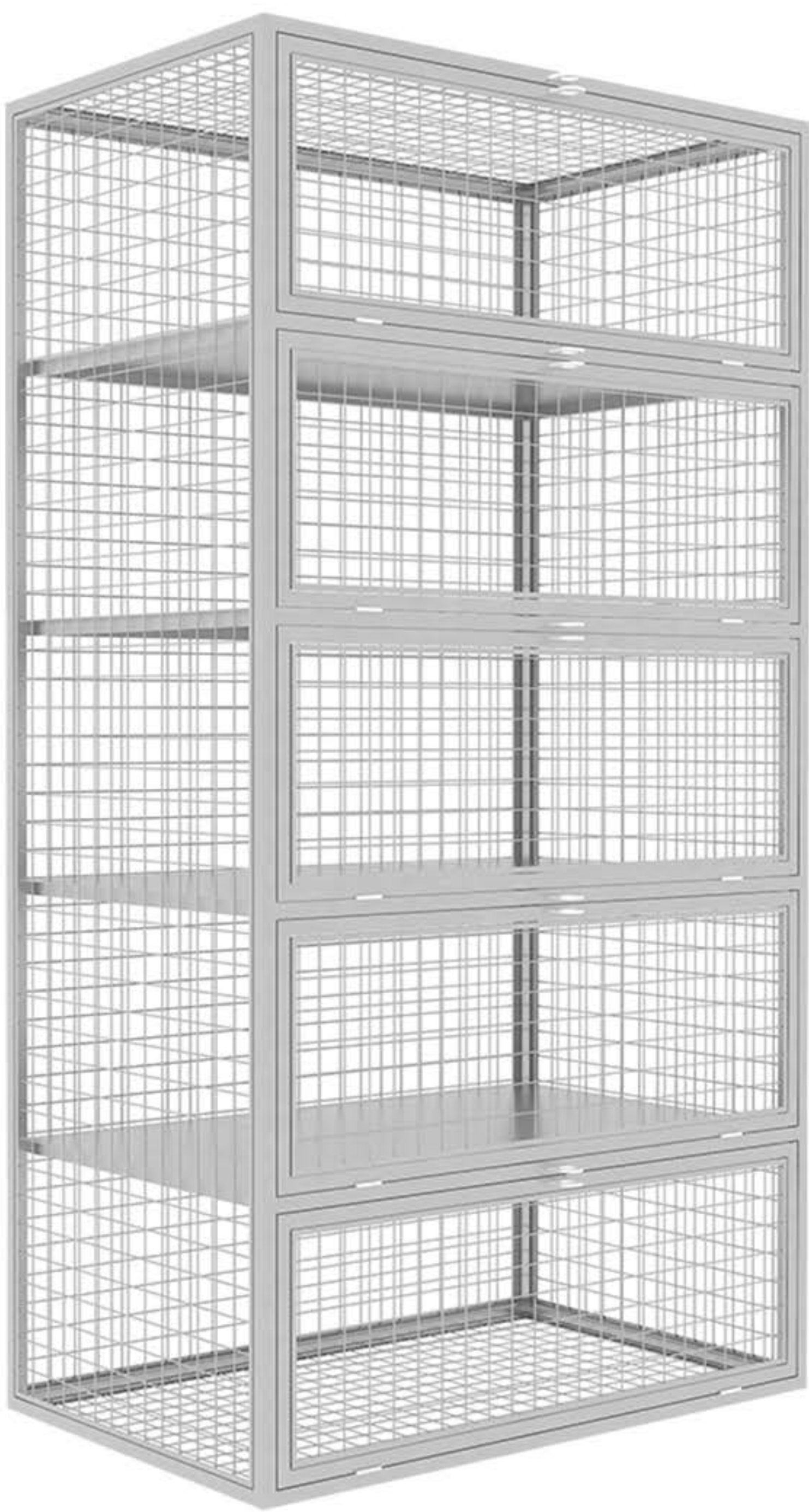

### Construction

- Steel tube frame 25\*25\*T1.2
- Panels is 50\*50\*T3.0 wire mesh
- Flip cover doors
- Solid steel shelf
- Standard dimension=1218x762xH2285MM
- Industrial hinge
- Latch padlock

### LEED

- Powder coated finish surface
- Customized color
- 90% recycle steel
- Made in Shenzhen China

### Different style of wire mesh wardrobe locker@3-column

Our mainly advantage wire mesh locker is custom made according client’s request.

Custom made mesh storage lockers including wardrobe mesh locker,mesh warehouse cage lockers,compartments storage locker and other custom made mesh lockers.

We can make any styles metal wire mesh lockers according client’s reques.

Contact us to design your style,now!

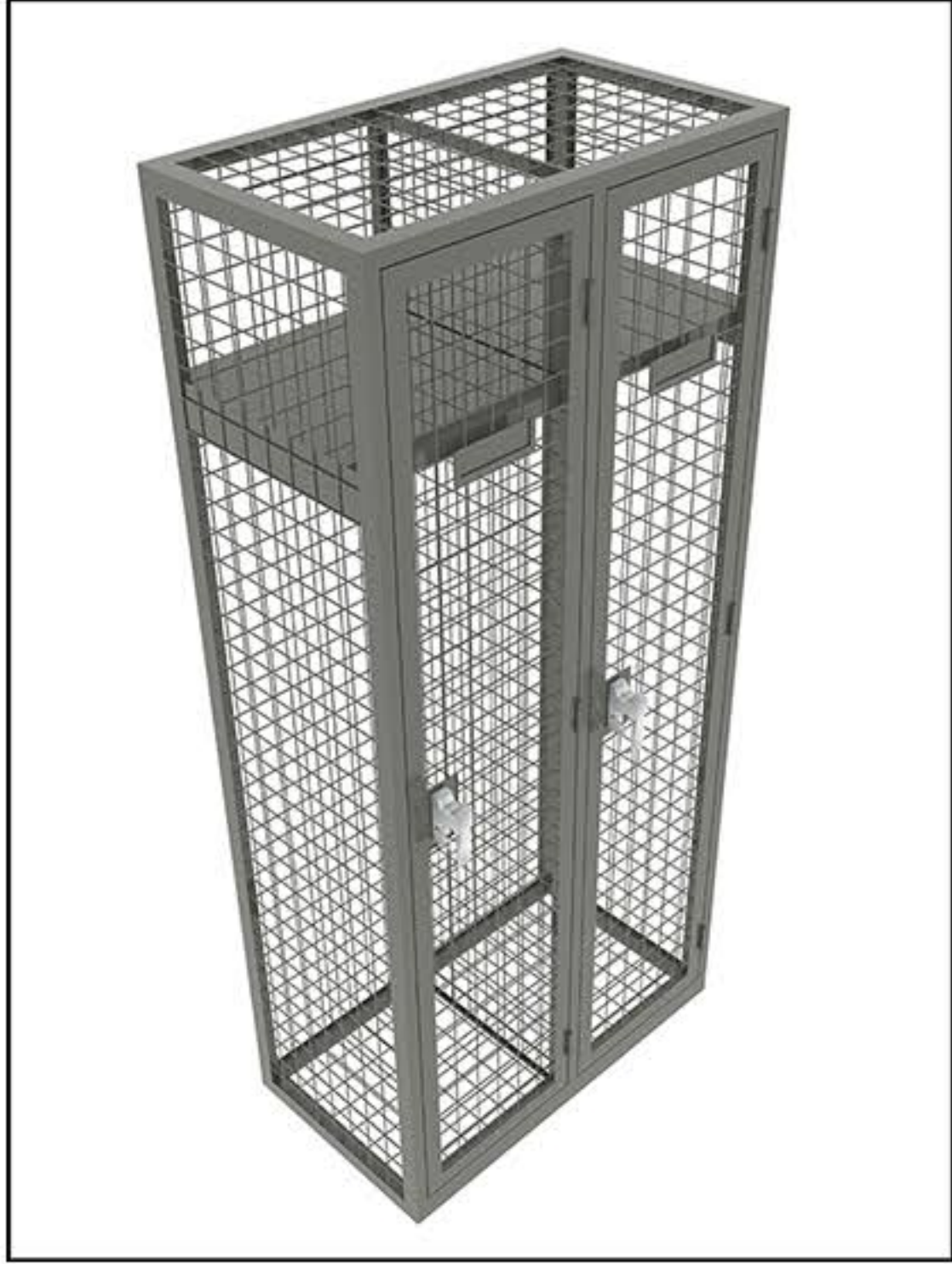

Mesh wardrobe locker

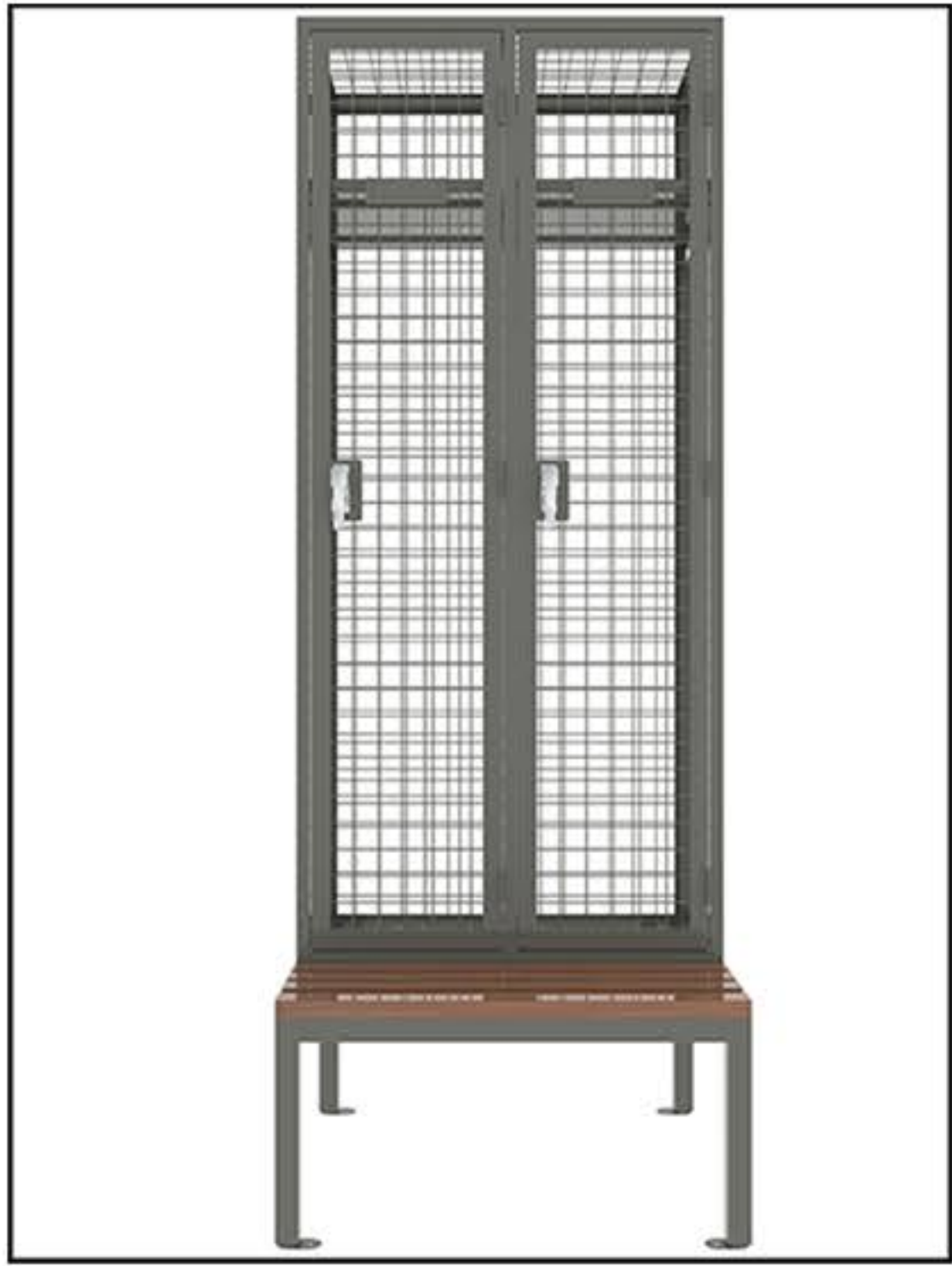

Locker with Bench

### Standard Locker

#### Construction

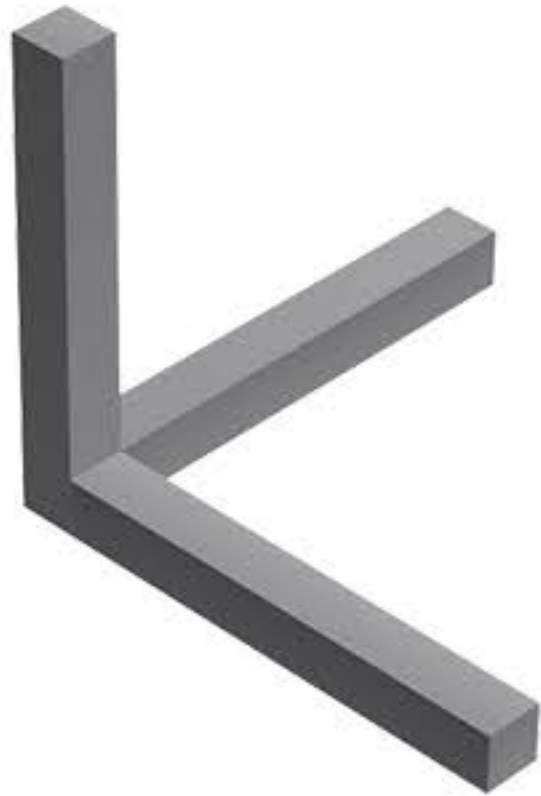

Steel Tube Frame  
25\*25\*T1.2

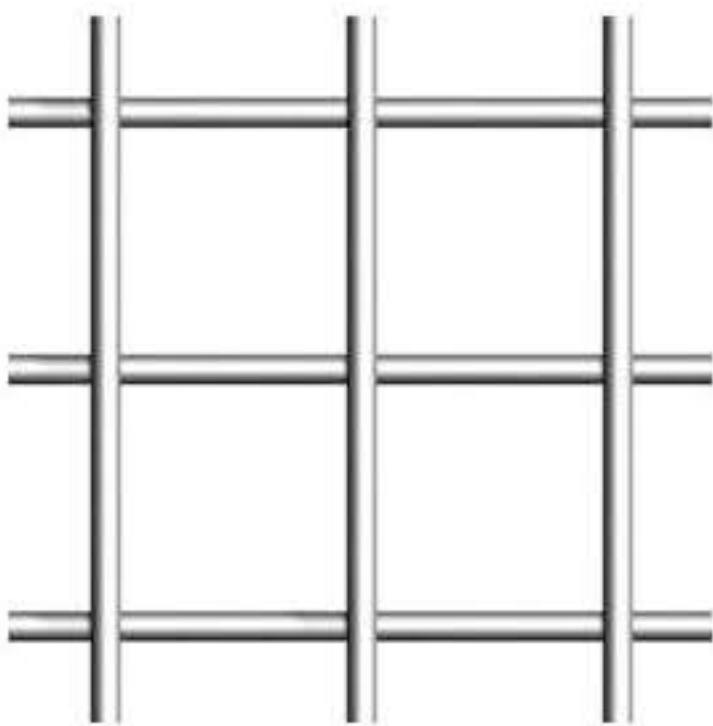

Wire Mesh  
Mesh is 50\*50\*T3.0

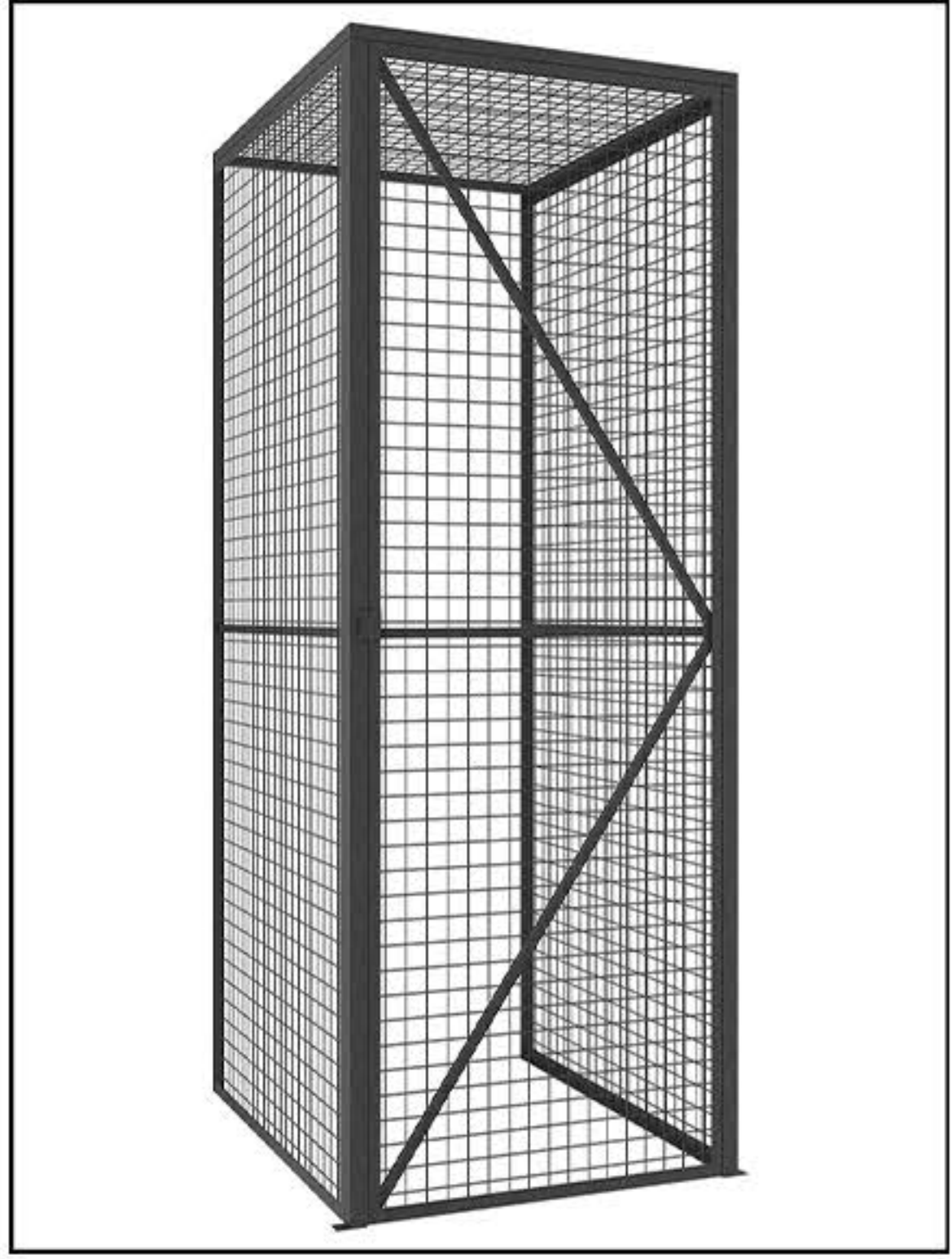

Warehouse cage locker

