



Address:Wanxing Industrial Area, Chanjing Village, Xinxu Town,
Huiyang District, Huizhou City, Guangdong, China,516000

www.goodlockers.com

Email:sales@goodlockers.com

Phone:+86 13632787893

METAL WIRE MESH BULK STORAGE LOCKER

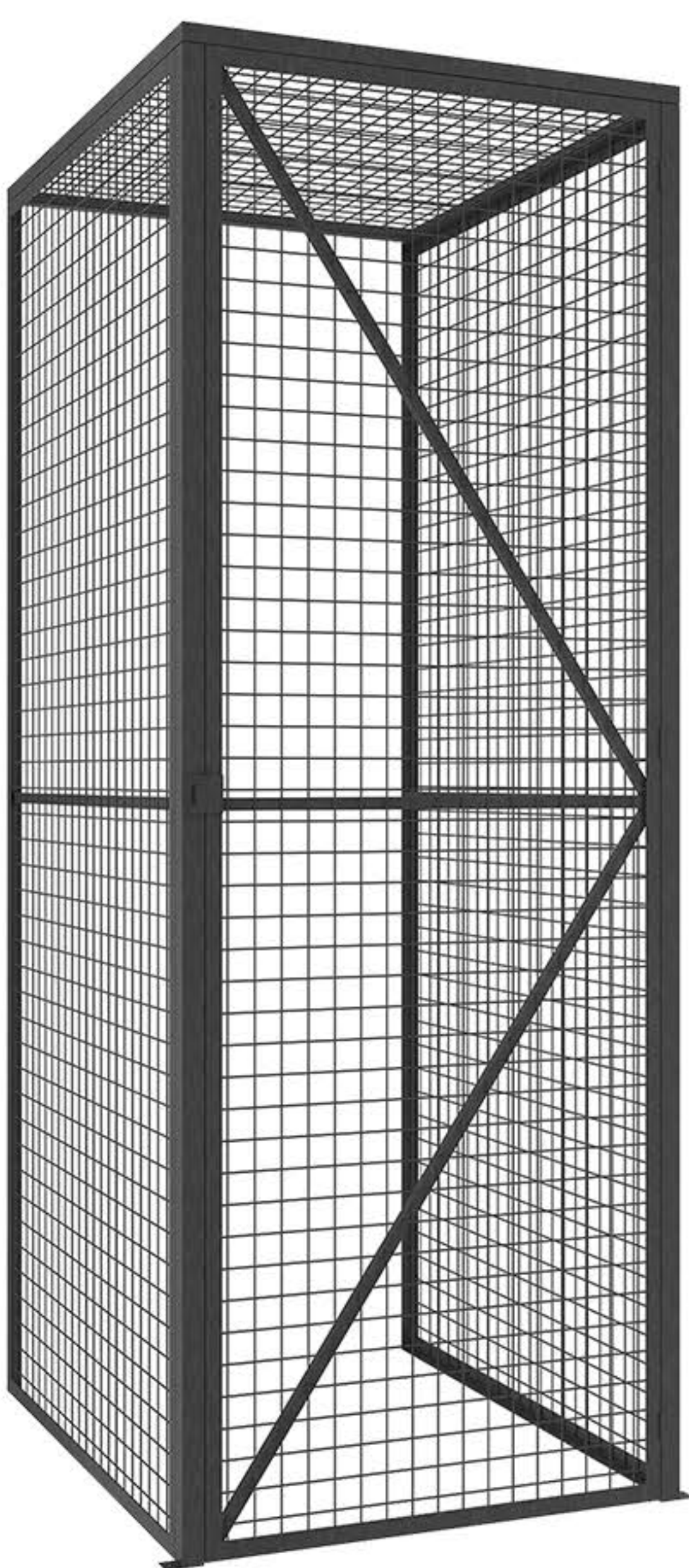

Construction

- Steel tube frame 25*25*T1.2
- Panels is 50*50*T3.0 wire mesh
- Single Door
- Without bottom and back panel
- Standard dimension=980x1200xH2400MM
- Industrial hinge
- Handle Padlock system

LEED

- Powder coated finish surface
- Customized color
- 90% recycle steel
- Made in Shenzhen China

2 Style of Wire Mesh Storage Cages Locker:

Our wire mesh cage lockers including two different styles,single tier and double tier.And single tier is easy to walk in unobstructed access.But if double tier,it is limited space for storing items.

There are other options,such as ceiling panel,bottom panel,back panel and lock,these items can be customized according specific request.

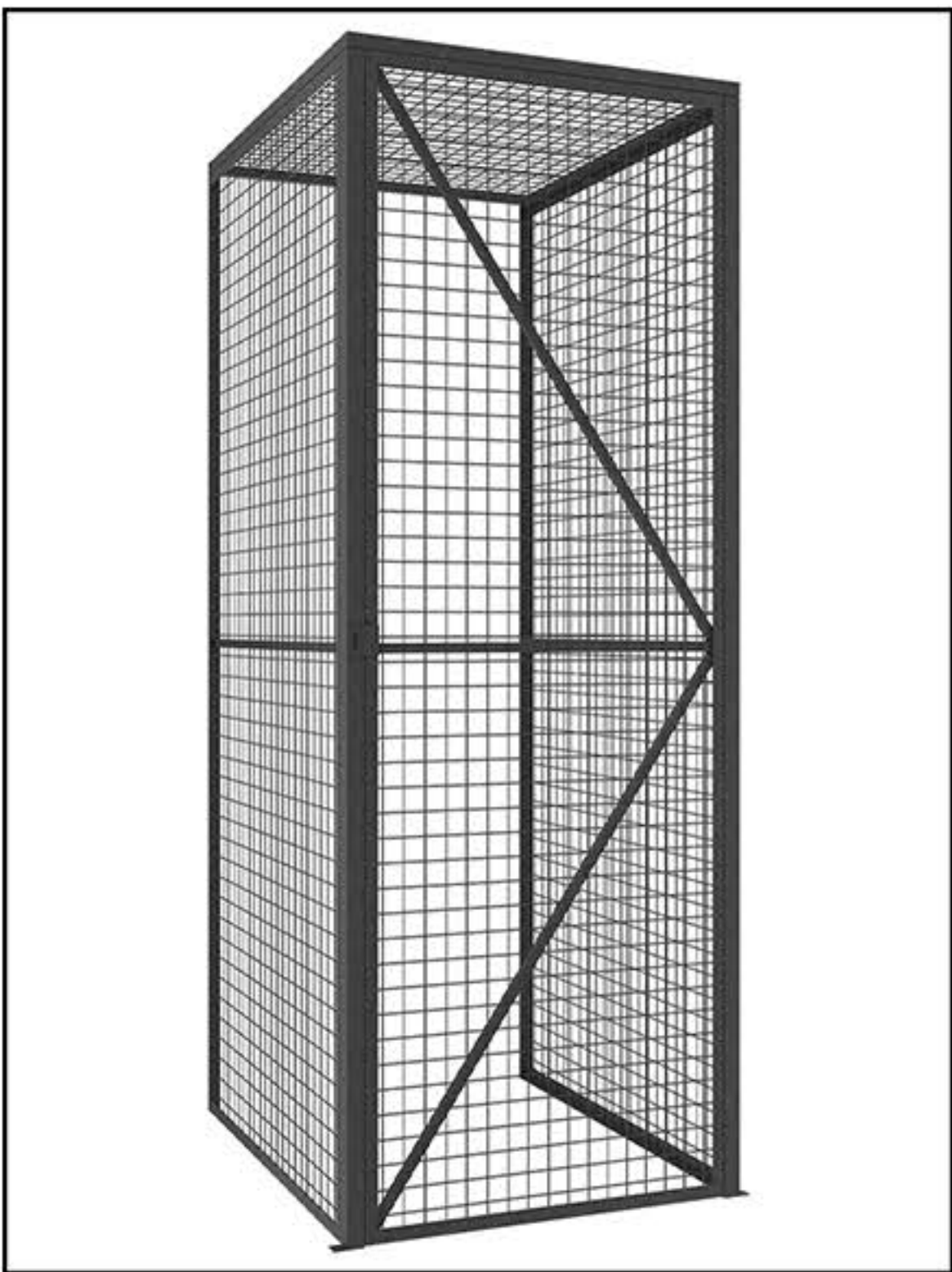

Single Tier

Standard Locker Construction:

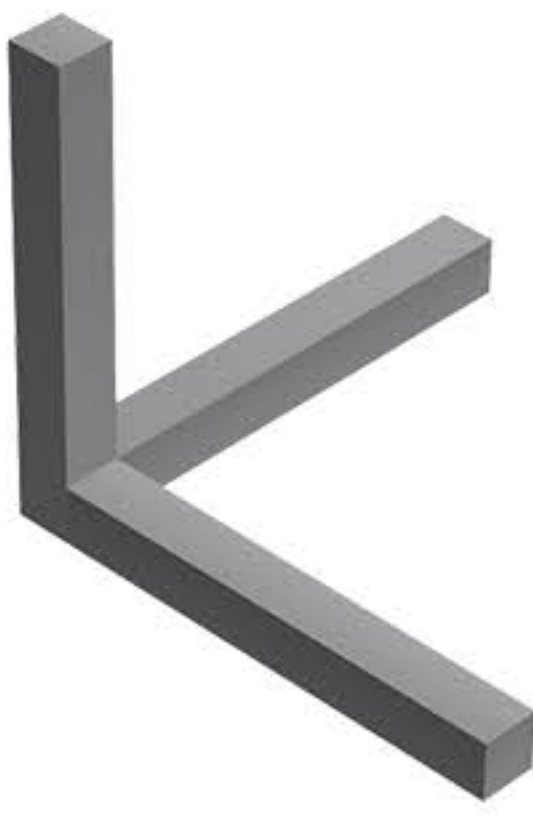

Steel Tube Frame
25*25*T1.2

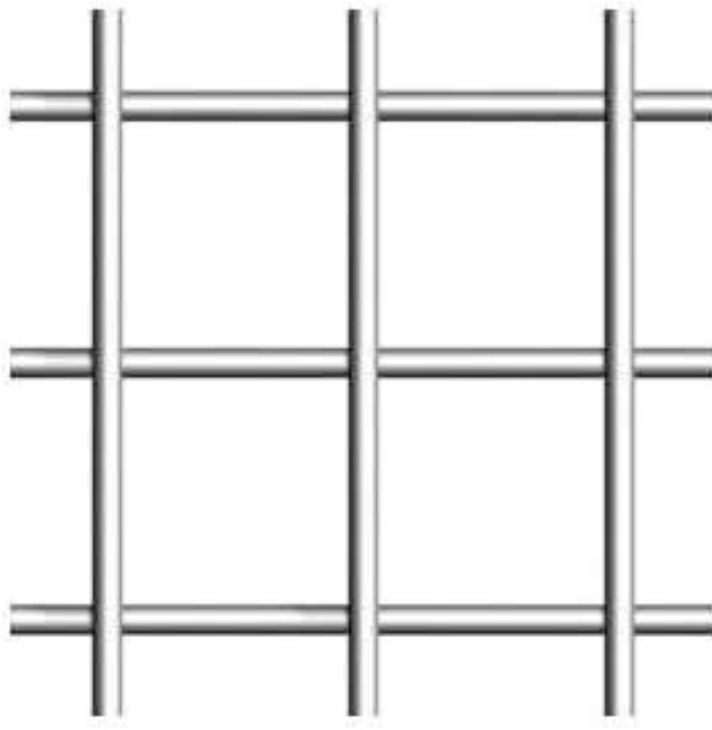

Wire Mesh
Mesh is 50*50*T3.0

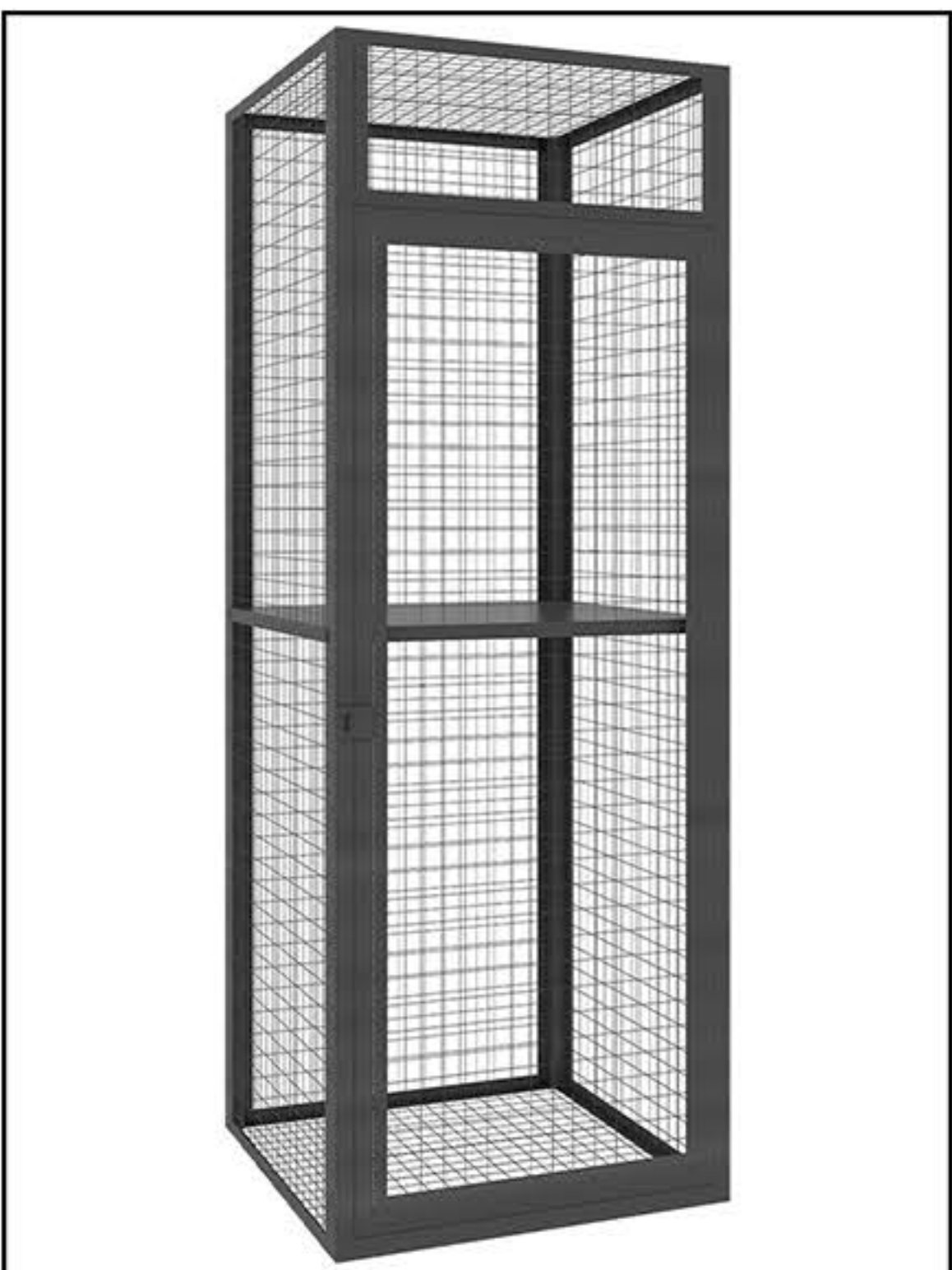

Double Tier

