



Address:Wanxing Industrial Area, Chanjing Village, Xinxu Town,
Huiyang District, Huizhou City, Guangdong, China,516000

www.goodlockers.com

Email:sales@goodlockers.com

Phone:+86 13632787893

METAL WIRE MESH WARDROBE LOCKERS

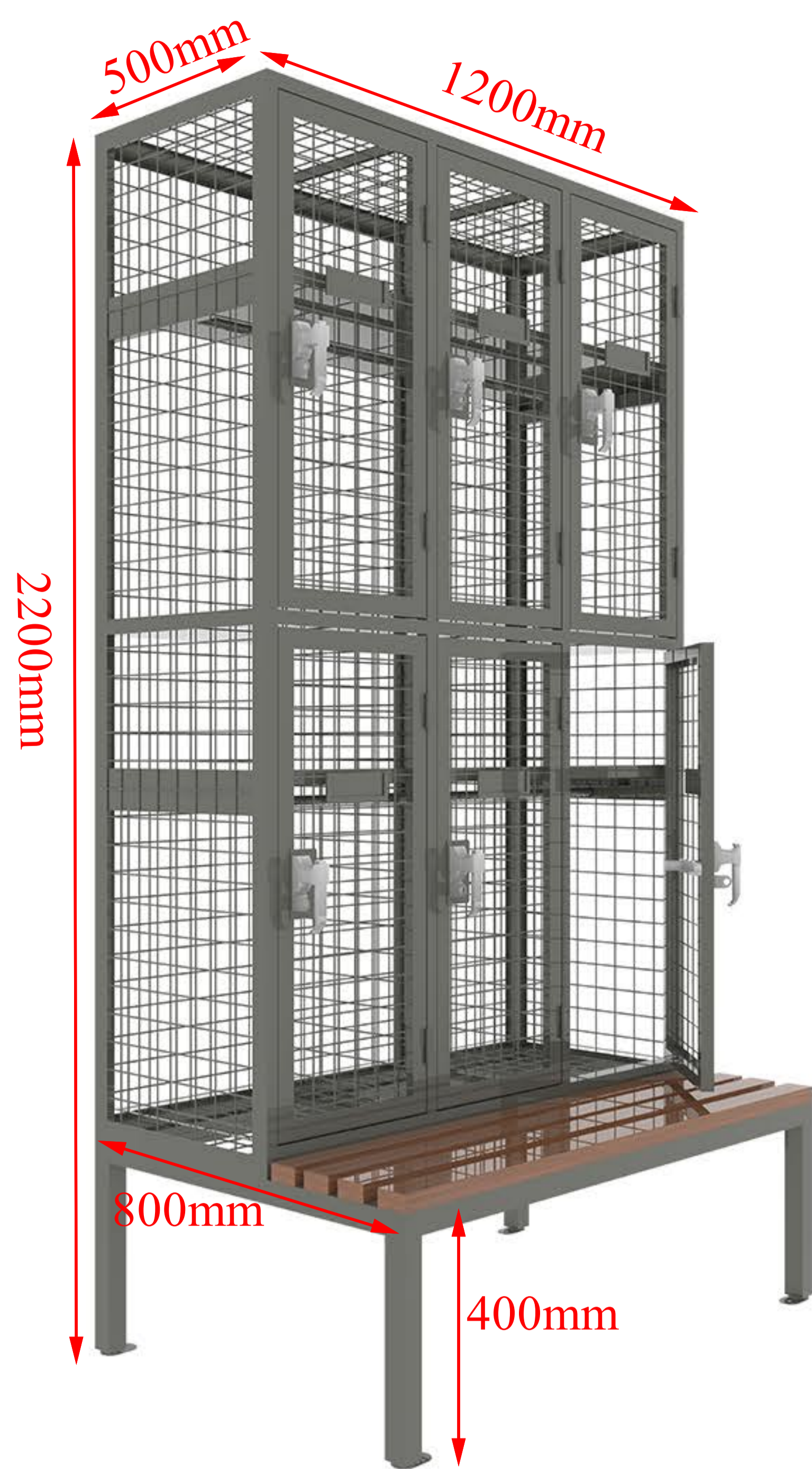

Construction

Steel tube frame 25*25*T1.2

Panels is 50*50*T3.0 wire mesh

Four compartments

Locker stand and seat bench

Shelf and hanger rail each door

Standard dimension=1200x500xH2200MM

Industrial hinge

Handle Padlock system

LEED

Powder coated finish surface

Customized color

90% recycle steel

Made in Shenzhen China

Different style of wire mesh wardrobe locker@3-column

Our wire mesh wardrobe locker comes in tree different styles:single tier can hang long clothes,but just for three person.If double tier,it can for 6 person but limit space.Another one is locker with bench.

We can make any styles mesh wardrobe locker according client's reques.

Contact us to design your style!



Single Tier



Double Tier

Standard Locker

Construction

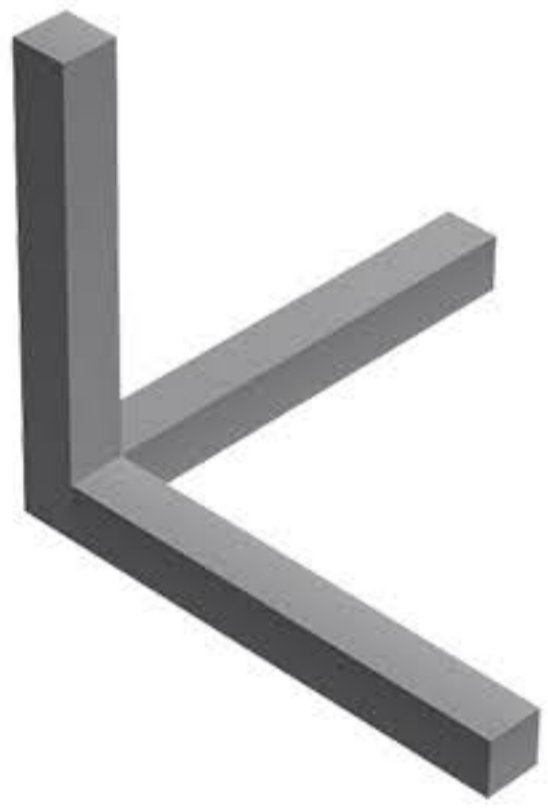

Steel Tube Frame
25*25*T1.2

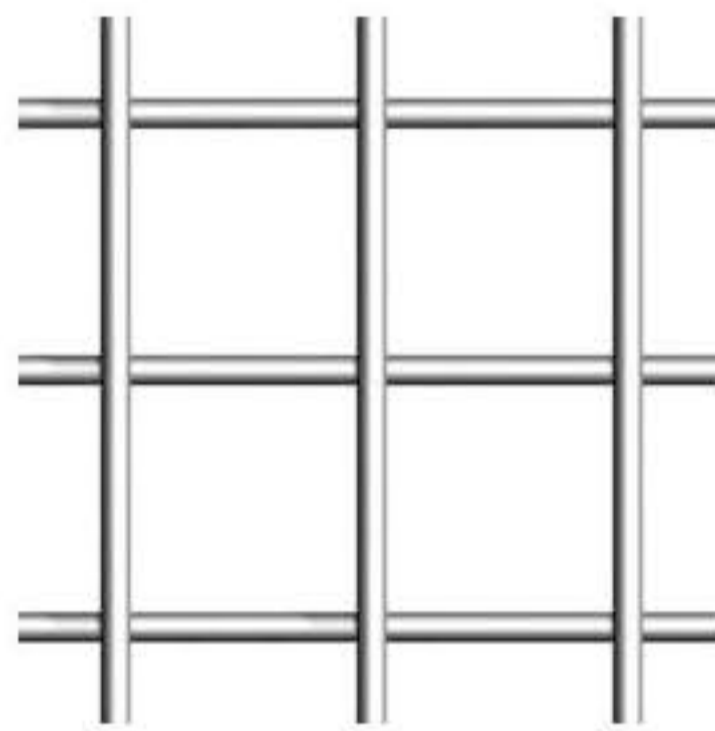

Wire Mesh
Mesh is 50*50*T3.0

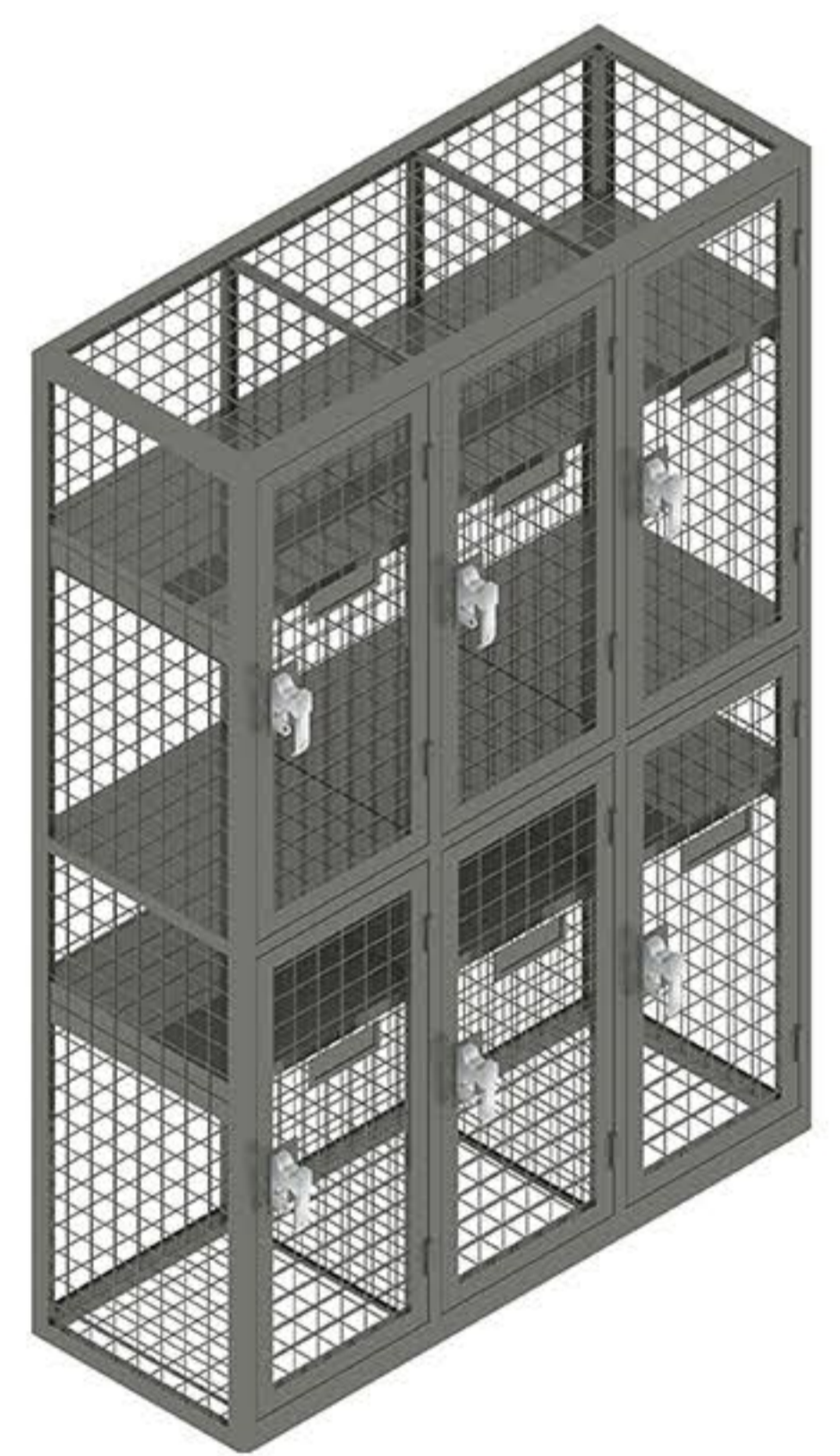

Locker without Bench

